

The Newark Museum of Art

49 Washington Street
Newark, NJ 07102-3176
newarkmuseumart.org
973.596.6550

MUSEUM HOURS

UpClose Wednesdays:
Reserved tours & school groups only. Call 973.596.6690 to reserve your tour
Thursdays: 10 am–7 pm
Fridays & Saturdays: 10 am–6 pm
Sundays: 10 am–5 pm
Closed Mondays (except MLK Jr. Day), Tuesdays, January 1, July 4, Thanksgiving Day & December 25.

ACCESSIBILITY

We are committed to making our collections, buildings, programs, and services accessible to all.



For additional information visit newarkmuseumart.org/accessibility

Amenities

SHOP

The Museum Shop & Junior Shop are open during Museum hours.

CAFÉ

Opening early 2020

PARKING

On-site parking available for a fee. Designated spaces available for visitors with disabilities.

Admission

\$15: Adults

\$8: Children (under 12), seniors & students (valid I.D.)

FREE for Members & Newark Residents.

PLANETARIUM

\$6: Adults

\$3: Children under 12, seniors & students

Members: \$3

SERVICES

Membership | 973.596.6686

Visitor Experience | 973.596.6699

Guidelines

No food or drink permitted in the galleries or auditorium.

PHOTOGRAPHY

Visitors are encouraged to take non-flash photography. Please be respectful of the artwork and other visitors while taking photographs or selfies.

CONNECT WITH US

[f](#) [t](#) [@](#) | [newarkmuseumart](http://newarkmuseumart.org)

Art Collections

The Newark Museum of Art's distinguished collections are international in scope and importance and span from antiquity to the present day. Here can be found the most significant historical collection of Tibetan art in the Western hemisphere, as well as collections of Japanese, Chinese, Korean, Indian and Southeast Asian art. The American art collection, on view in *Seeing America*, ranges from the *Native Artists of North America* to superb Hudson River School landscape paintings, folk and outsider art, as well as major works of modern and contemporary art in all media. Extensive holdings of African art include masks and other sculpture, ceramic vessels, dress and adornment, as well as photography, painting and video art. Collections of ceramics, glass, silver, jewelry, furniture and textiles comprise the considerable Decorative arts collection. Ancient art is also well represented in the Museum's collection with objects from Egypt, Greece and Rome.

SEEING AMERICA

This permanent installation presents an expanded view of American art and culture from the 17th century to present. "American Voices," a key component of the Museum's new Modern and Contemporary galleries, showcases contributions from the broader community with bilingual labels throughout the 2nd floor. Twelve eye-opening thematic galleries highlight the many aesthetic traditions that make up American art.

DREYFUSS PLANETARIUM

Visitors can explore the constellations, travel through the solar system, and visit distant galaxies in the Alice and Leonard Dreyfuss Planetarium. This spectacular 50-seat theater features a state-of-the-art Zeiss ZKP3B projector that displays up to 7,000 stars, displaying the correct positions of the Sun, Moon, and planets.

BALLANTINE HOUSE

Built in 1885 by members of the celebrated Newark beer-brewing family, this mansion was designated a National Historic Landmark in 1985. Visitors can wander through history in *House & Home*, a suite of Victorian-period rooms and accompanying thematic galleries depicting the era's influence on interior decorating from then until now.

TIBETAN BUDDHIST ALTAR

In 1990 His Holiness the 14th Dalai Lama visited The Newark Museum of Art expressly to consecrate this extraordinary Tibetan Buddhist altar within the Museum's galleries. Linking the past with the present, the altar encases portions of a previous Tibetan altar the Museum constructed in 1935.

About

The Newark Museum of Art was established in 1909 by founding director John Cotton Dana to promote the appreciation, understanding, and enjoyment of the arts and sciences to all members of the community. This historic commitment to broadening arts participation continues today, as the Museum strives to actively engage diverse communities and voices, and to make its collections, facilities, programs and services accessible to all audiences. Consistent with its founding vision, the Museum seeks to advance the principles of diversity, equity, accessibility and inclusion in all aspects of its work and institutional structures.

Arts District

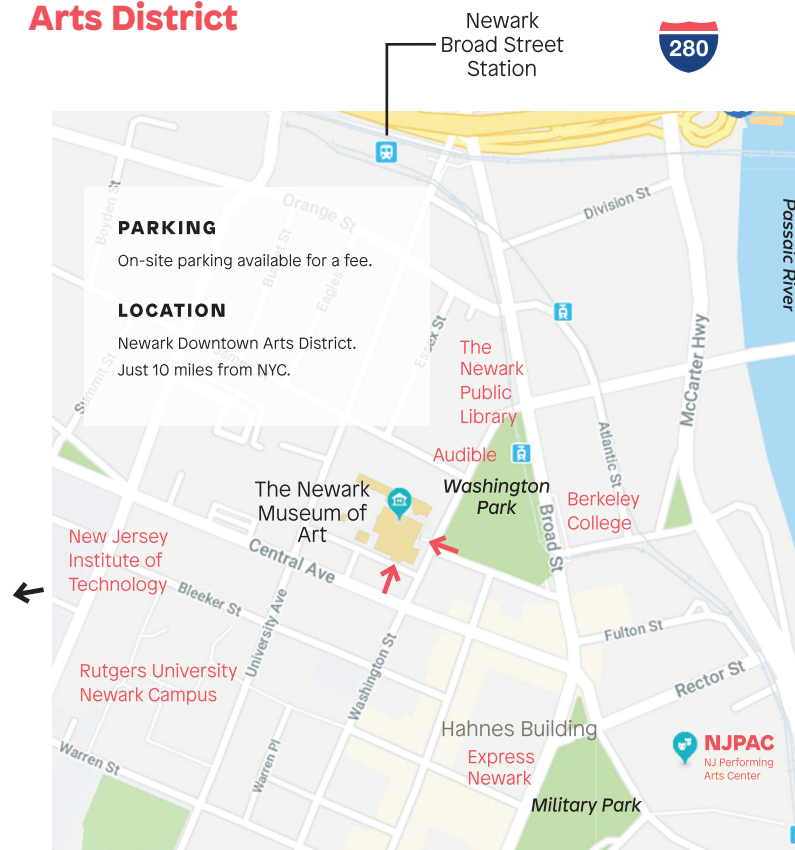

Visitor Guide made possible by PSEG Foundation

The Newark Museum, a not-for-profit museum of art and science, receives operating support from the City of Newark, the State of New Jersey, the New Jersey State Council on the Arts/Department of State (a partner agency of the National Endowment for the Arts), the New Jersey Cultural Trust, the Prudential Foundation, the Geraldine R. Dodge Foundation, the Victoria Foundation, the PSEG Foundation, the Estate of Phyllis and Sanford Bolton, the Wallace Foundation, and other corporations, foundations, and individuals. Funds for acquisitions and activities other than operations are provided by members and other contributors.



To Newark Penn Station →

Visitor Guide

THE
NEWARK
MUSEUM
OF
ART

THE
NEWARK
MUSEUM
OF
ART

FIRST FLOOR

CONNECT TO ALL MUSEUM BUILDINGS AND GALLERIES ON FIRST FLOOR ONLY

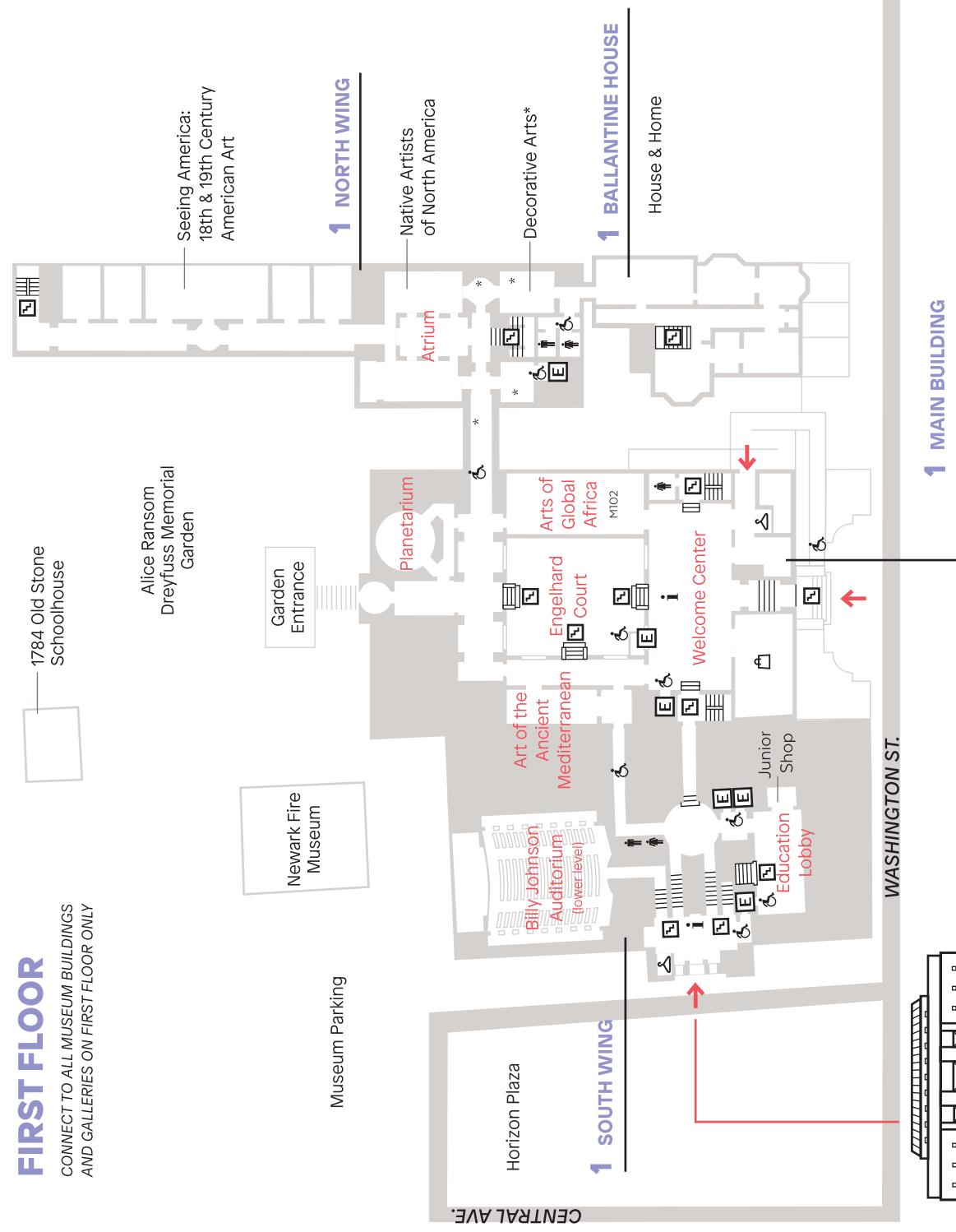

SOUTH WING

MAIN BUILDING

BALLANTINE HOUSE NORTH WING LOCATED AT REAR

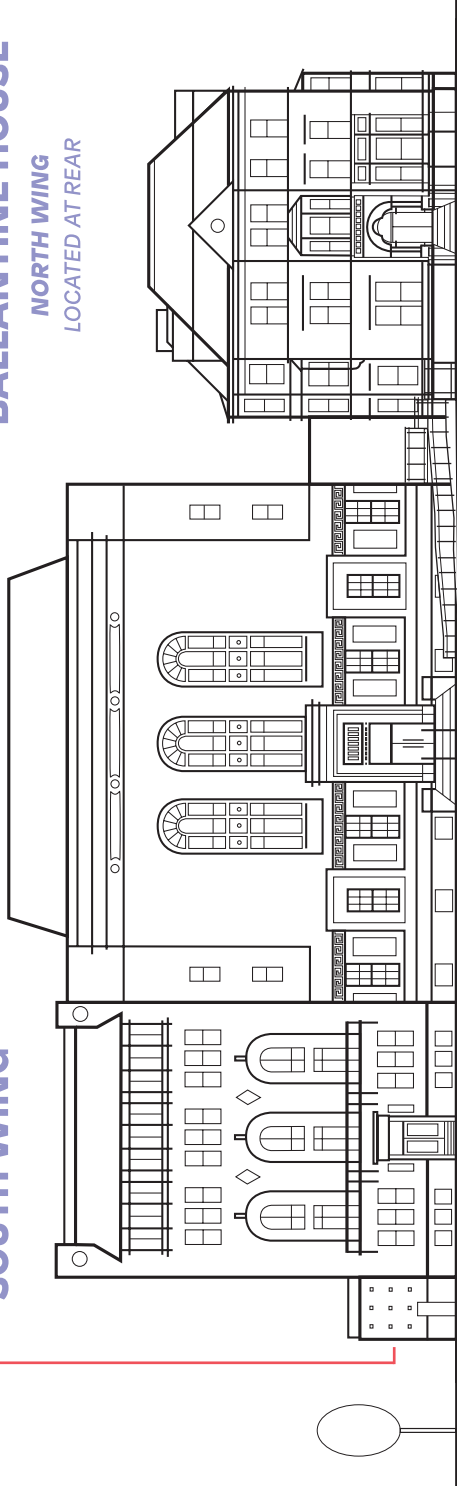

Key

- Entrance ↑
- Information i
- Handicapped Access ♿
- Elevator E
- Stairs ⚡
- Coatroom 🧥
- Shop 🛍
- All Gender Restrooms 🚻
- Ladies' Room 🚺
- Men's Room 🚻

SECOND FLOOR

RETURN TO THE FIRST FLOOR TO CONNECT TO OTHER BUILDINGS

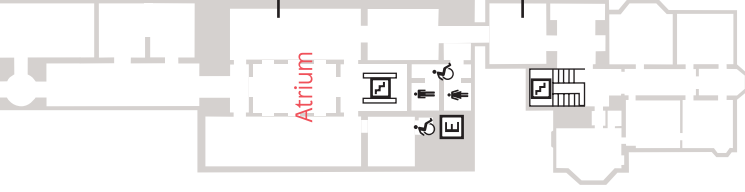
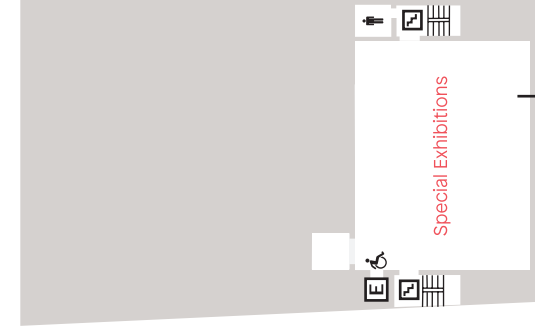
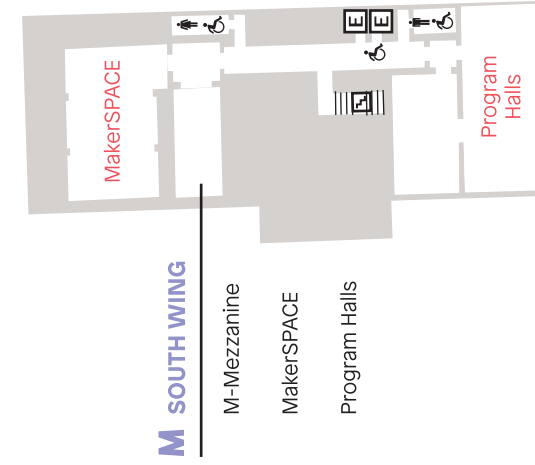

THIRD FLOOR

RETURN TO THE FIRST FLOOR TO CONNECT TO OTHER BUILDINGS

